

REVISION RECORD			
REV.	CONTENT	MOD.	DATE
△	初版发行		

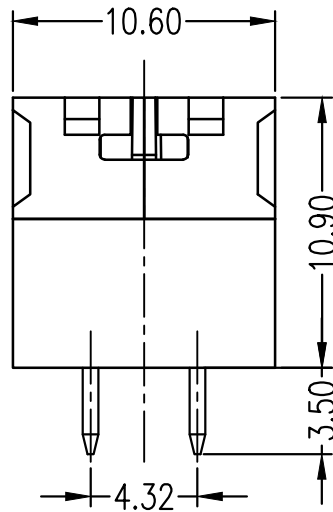
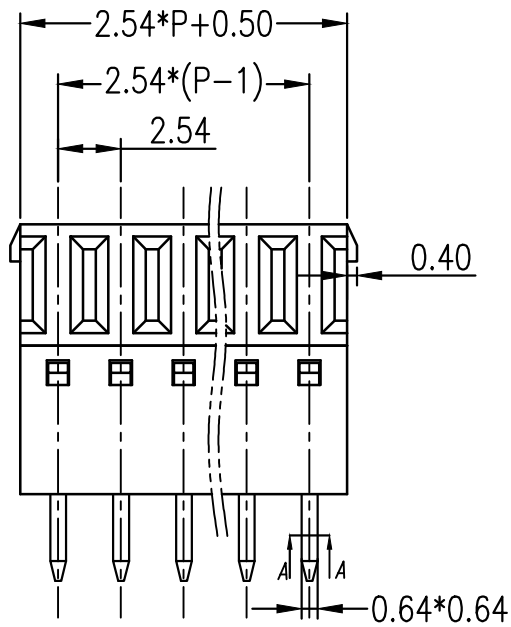
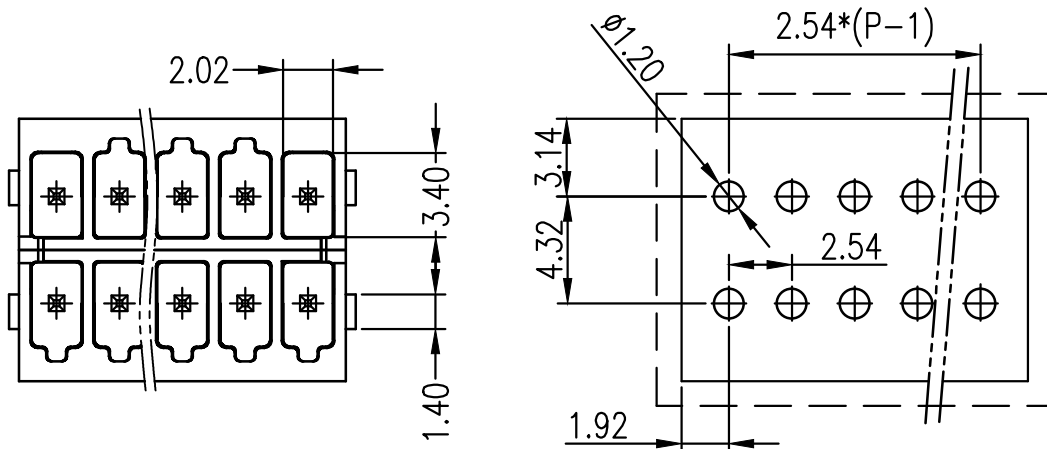

NOTES:

1. Voltage Rating: 160V, Current Rating: 6A
2. PITCH: 2.54mm
3. Insulation Withstands Voltage: AC2000V/min
4. Insulation Resistance: 2.0 MΩ or more at DC500V
5. Using Temperature Range: -40°C ~ +105°C
6. Suitable Electric Wire: 26-20AWG

技术要求:

1. 额定电压: 160V, 额定电流: 6A
2. 间距: 2.54mm
3. 耐电压值: AC 2000V/min
4. 绝缘阻抗 2.0兆欧
5. 使用条件: -40°C ~ +105°C
6. 适用线规: 26-20AWG

	pitch dimension			Nominal dimension					—
	over 0	over 6	over 10	over 0	over 30	over 60	over 100	over 150	
variable range	to 6	to 10	to 24	to 30	to 60	to 100	to 150		
Tolerance	±0.1	±0.15	±0.25	±0.2	±0.3	±0.5	±0.7	±1.0	0.05/10

3	LZ4-2.54直针	1008B0003AV	2P	黄铜	镀亮锡
2	LZ4-2.54主体	1172A0YXXAV	1	PA66	
1	LZ8-2.54主体	1168A0YXXAV	2	PA66	
NO.	NAME OF PART	NO. OF PART	Q'TY	MATERIAL	NOTES
DES.	吴央阳	DATE	24-02-17	UNITS	mm
CHK.	张华丰	DATE	24-02-17	SIZE	A4
APP.		DATE		SCALE	1:1
				DWG NO.	SP-2-1172001
				REV.	V0
上海有乐电气有限公司 Shanghai YouLe Electric CO.,LTD				TITLE	LZ4V-2.54-2*XXP-1Y/1Y-00A
					LZ4V-2.54-成品